

For Lease

Timberlands Commercial Developments

499 Timberlands Drive, Red Deer, AB, T4P 0Z3



Welcome to the town of Red Deer

Prime retail leasing opportunity!

Hani Abdelkader Principal

403 232 4321 hani.abdelkader@avisonyoung.com

Josh Rahme Principal

403 232 4333 josh.rahme@avisonyoung.com

Morena Ianniello Senior Client Services Specialist

587 293 3367 morena.ianniello@avisonyoung.com

**AVISON
YOUNG**

Aerial and Nearby Amenities



Timberlands Commercial Developments

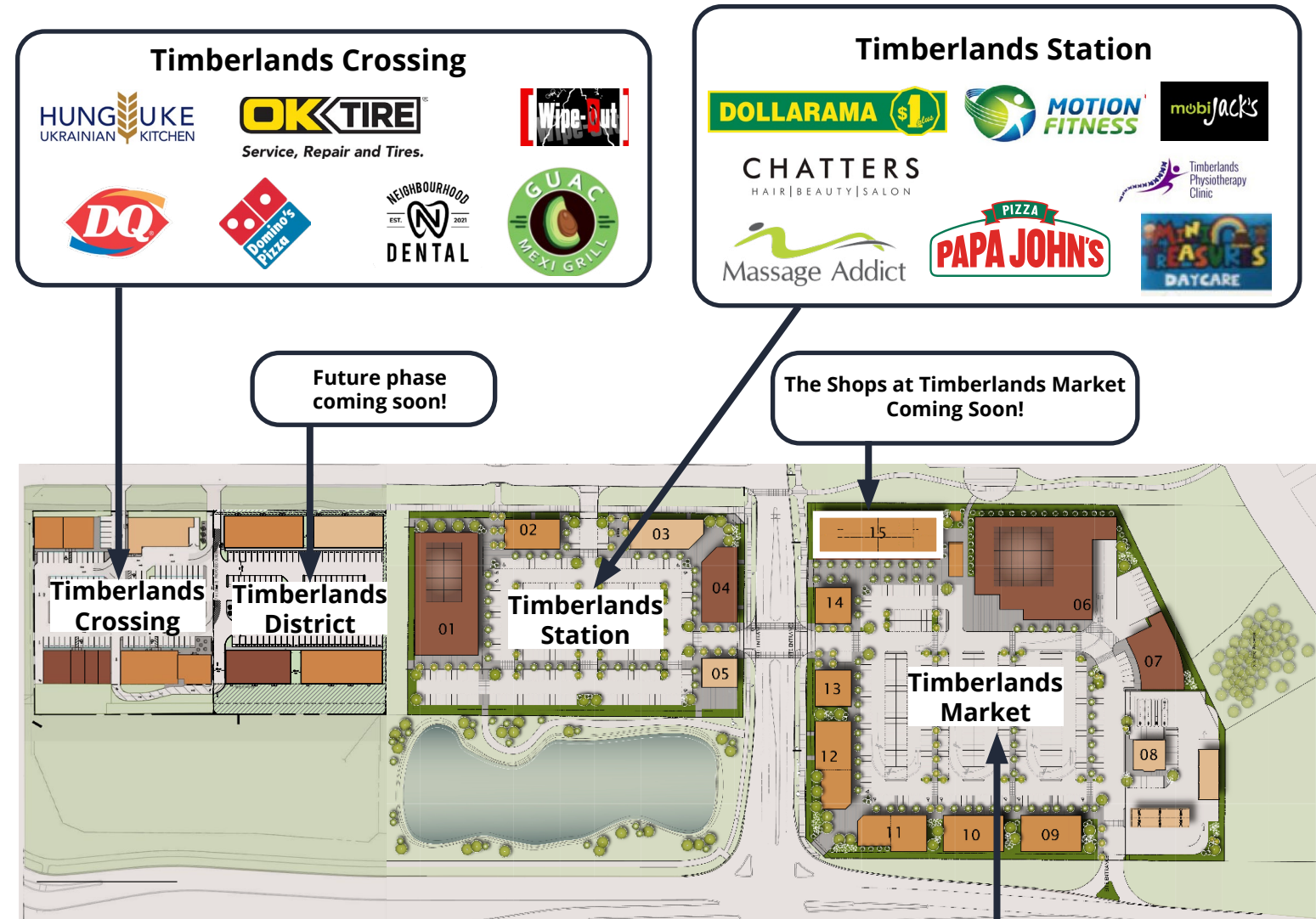

Timberlands Crossing

Highlights

Property anchored by OK Tire, DQ, and many local retail tenants.

38,000 vehicles per day along 30th Avenue.

Serving communities of Clearview Ridge, Clearview Meadows, Rosedale Estates and Rosedale Meadows

Particulars

Address: 90 Thornburn Avenue
Red Deer, AB, T4P 0Z3

Available: Unit 2120: 1,603 sf
Unit 2130: 1,130 sf
Unit 2140: 1,129 sf
Unit 2150: 1,333 sf

Timing: 60 days' notice
Additional Rent: \$12.80 psf (est. 2024)
Zoning: TBD
Rents: Market



Floor Plan

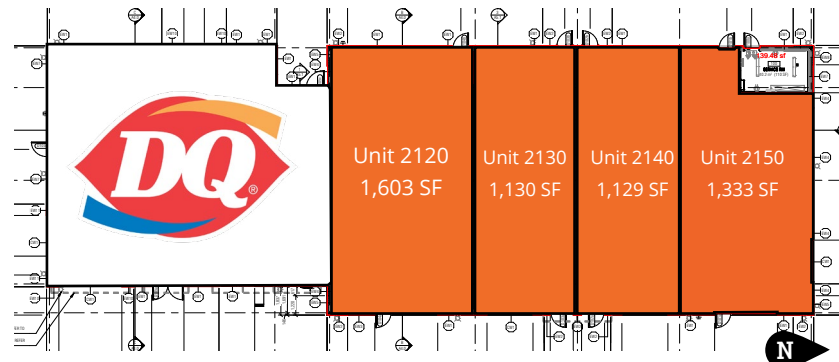

Leased
 Under Offer
 Conditionally Leased
 Available

Anchor Tenants



The Shops at Timberlands Market

Highlights

Prime retail opportunity in newly developed The Shops at Timberland Market.

Particulars

Available: 7,910 sf
Occupancy: Immediate
Additional Rent: TBD
Zoning: TBD
Rents: Market

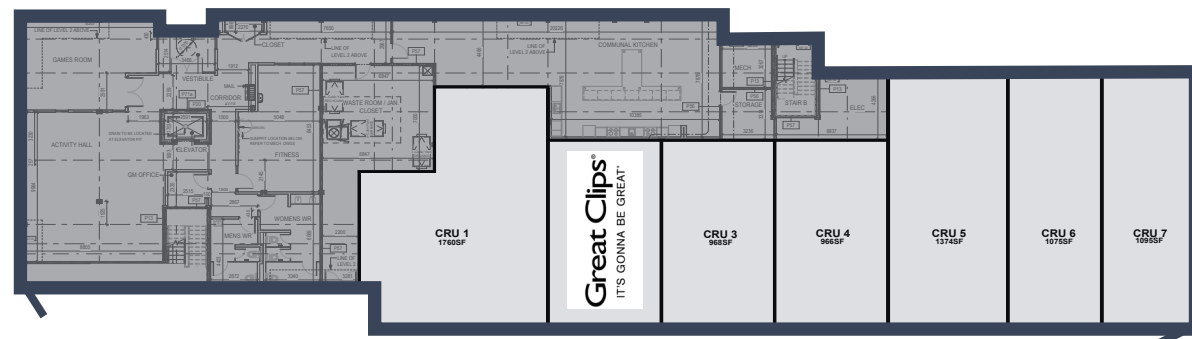

Leased
 Under Offer
 Conditionally Leased
 Available

Renderings





Get more info.

Hani Abdelkader Principal
403 232 4321 hani.abdelkader@avisonyoung.com

Josh Rahme Principal
403 232 4333 josh.rahme@avisonyoung.com

Morena Ianniello Senior Client Services Specialist
587 293 3367 morena.ianniello@avisonyoung.com

Visit us online
[avisonyoung.com](https://www.avisonyoung.com)